



quick guide

RBANDSPC

Solar panel cover for Radioband/TBX
with battery connector

EN

Introduction

The RBAND SPC must be installed in such a way that it receives enough solar radiation (place the solar panel towards the sun and avoid light blocking obstacles).

The orientation is towards the south, not being recommended towards the north.

ORIENTATION	EFFICIENCY
SOUTH	Very good
SOUTH-WEST / SOUTH-EAST	Good
WEST / EAST	Regular
NORTH-WEST / NORTH-EAST	Bad
NORTH	Very bad

Installation



1.- Remove the Radioband/TBX cover with a screwdriver.

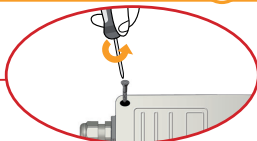

2.- Disconnect the battery connector from the board.

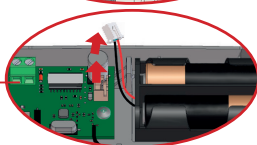

3.- Remove the existing batteries

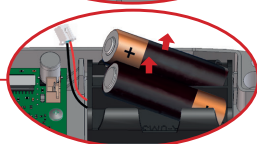

4.- Insert the supplied rechargeable batteries in the correct position.

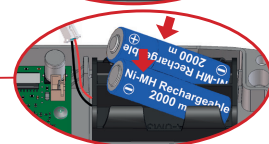

5.- Connect the battery connector to the RBAND SPC male connector (A), and the RBAND SPC female connector to the electronic board (B).

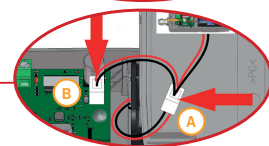

6.- Cover the RADIOBAND/TBX with the RBAND SPC.

EC declaration of conformity

JCM TECHNOLOGIES, S.A., declares herewith that this product is in compliance with the essential requirements and other relevant provisions of Directive 1999/5/EC and complies with the fundamental requirements of the 2004/108/EC Directive on electromagnetic compatibility and 2006/95/EC on low voltage, insofar as the product is used correctly.

See web www.jcm-tech.com