



jcmtechnologies
quick guide



Technical Data

- 868 MHz (radio) / 13,56 MHz (card) • IP54 •
- 1 x 3,6V ER17335M Lithium Battery (1500 mAh) •
- Op. temperature -20°C to +70°C • 10000 cycles •

KEELock

Electronic cylinder for
residential installations

EN

Programming

PROG

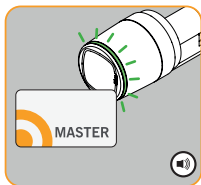

Enter programming mode.

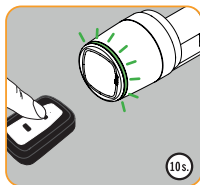

Press the transmitter button to program.

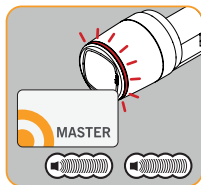

Exit programming mode.

Operation

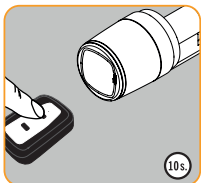

Press transmitter buttons to open the door.

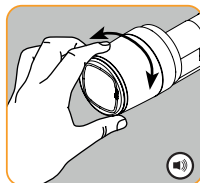

Wake up.

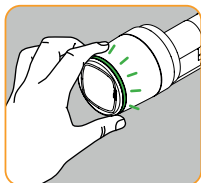

Transmitter validated.
Cylinder unlocked.

If after unlocking the light becomes red instead of green, the device is informing that a battery replacement is needed.



Single reset

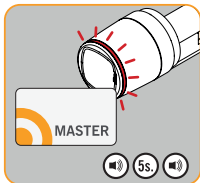

Enter reset mode.

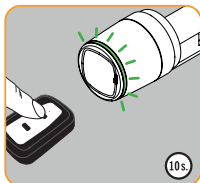

Press the transmitter button to reset.

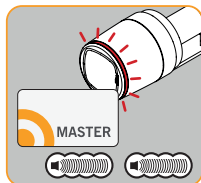

Exit reset mode.

Total reset



Enter programming mode.

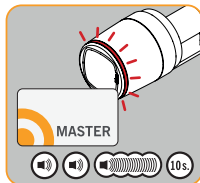

Enter total reset mode.

If there is no activity in 10 seconds, the device will exit from configuration mode.

Problem solving

See our website for troubleshooting: www.jcm-tech.com/JCM/keelock/

Regulatory Data

EU Declaration of conformity

The manufacturer **JCM TECHNOLOGIES, S.A.** declares that the product **KEElOCK** complies with the relevant fundamental requirements of the RED Directive 2014/53/EU and of the RoHS Directive 2011/65/EU.

UKCA Declaration of conformity

The manufacturer **JCM TECHNOLOGIES, S.A.** declares that the product **KEElOCK** complies with the relevant fundamental requirements of the Radio Equipment Regulations 2017 and of the RoHS Regulations 2012.

See website www.jcm-tech.com/en/declarations

JCM TECHNOLOGIES, SA - COSTA D'EN PARATGE, 6B - 08500 VIC (BARCELONA) SPAIN

QG_3200823_KEELOCK_EN_Rev03

